

# Northwest Cluster

---

Northwest High School

Kingsview Middle School

Lakelands Park Middle School (shared)

Roberto Clemente Middle School (shared)

Clopper Mill Elementary School

Darnestown Elementary School

Diamond Elementary School

Germantown Elementary School

Great Seneca Creek Elementary School

Ronald McNair Elementary School

Spark M. Matsunaga Elementary School

---

## FY 2009-2014 CIP Testimony

### to the County Council

February 6, 2008

Good evening President Knapp and Council members. My name is Susan Burkinshaw and I am here tonight with my partner Bob Murphy as the Northwest Cluster Co-Coordiators.

We understand that we are in a very tight fiscal situation at this time. We also understand that this is a great opportunity to stop, evaluate processes and take the opportunity to improve efficiencies across our County's systems in order to save expenditure waste to keep dollars available so you won't be faced with having to cut personnel salaries and benefits.

One way to do this is through the CIP process. As we have seen with Ridgeview Middle School, the plan for a complete modernization has been scrapped and a new feasibility study for a phased in modernization has been implemented—given our current fiscal crisis, it is apparent that in the future the county should adopt a policy that all feasibility studies across the county should facilitate construction in phases.

We understand that there is a current modernization schedule based on 1999 recommendations (see attached), and since Darnestown ES is not already on it, they are not likely to be modernized before 2020. There is a looming crisis at the aging Darnestown Elementary School facility that must be evaluated immediately. This facility is now in the queue for a modernization no sooner than 2020, however, they have been recommended to be added to the CIP for a feasibility study for a classroom addition in the 2009 budget.

Built in 1954, Darnestown is currently running at over 40% over core capacity. Not only has a septic system that has begun to show signs of imminent failure (it is now scheduled for replacement this summer), but also it has a core academic facility that has not been renovated since a 1965 classroom addition (NOTE: this was 43 years ago, likely before most of the parents and staff and faculty, and even some of you, were

## **Northwest Cluster Testimony February 6, 2008(cont'd)**

born). The gym was added in 1974 and a small administrative and storage addition was made in 1980—28 years ago. As a point of reference, College Gardens was just completely rebuilt and their original construction date was 1967—two years after Darnestown's last classroom addition.

If a ship is heading for an iceberg isn't it better to stop, re-evaluate the course and navigate around the obstacle, rather than to keep moving ahead full force and implement emergency search and recovery operations after it hits? There is no question that emergency repairs will need to be made on an ongoing basis at the Darnestown facility—tying up critical financial and personnel resources that could be available across the county. Since Darnestown ES has been recommended for feasibility study for an addition in the current CIP, we feel that it would be appropriate to also combine the construction plans to include a modernization at the present time, if even as a phased in construction approach.

There are new "green" facilities, like Great Seneca Creek Elementary School, that are three times bigger than Darnestown ES in terms of square footage, but have electric bills that are 20% less than Darnestown's. Our school buildings need to at least be evaluated during the feasibility studies in a more holistic approach and perhaps have phased in renovation plans laid out so they can be implemented as future funds become available. For example, an individual feasibility study could yield an extended multi-year, cohesive, phased-in addition and modernization plan, instead of performing new feasibility studies each year to address facility crises as they occur.

In any case, we cannot let the assets of the county fall into such disrepair and expect emergency funds to sustain them. Since Darnestown ES is scheduled for the feasibility study for an addition, we respectfully request that a complete modernization feasibility study be done in conjunction with the addition feasibility study so as to maximize on cost efficiencies—if something is being done as part of the addition and labor and materials can be shared with the modernization, this should be done so as to expedite modernization work at Darnestown in advance of the 2020 date advised by MCPS staff.

In recent years we saw construction costs more than double for an addition at Matsunaga Elementary School done two years after the original construction of the building—we don't want to see any more waste from poor planning in such a tight economic climate.

With a holistic review of Darnestown Elementary School's situation now we believe the County will save tax-payer dollars over the long run by minimizing the need for expensive, emergency "band-aid" fixes there. We are sure that a more cost-efficient solution would be to expand the scope of the current feasibility study to evaluate and plan out a more comprehensive, if not phased in, overhaul of the entire aging facility.

Thank you for your consideration.

*Respectfully submitted by:*

*Susan Burkinshaw and Bob Murphy, 2007-8 Northwest Cluster Co-Coordinators*

Attachments

## Modernization Schedule for Assessed Schools

Schools	Year Built	Year Renovated	FACT Score	Approved Schedule
<b>Elementary</b>				
College Gardens	1967		1282	1/2008
Cashell	1969		1292	8/2009
Galway	1967		1301	1/2009
Cresthaven	1962		1311	8/2010
Carderock Springs	1966		1316	8/2010
Bells Mill	1968		1319	8/2009
Cannon Road	1967		1357	1/2012
Garrett Park	1948	1973	1388	1/2012
Farmland	1963		1417	8/2011
Seven Locks	1964		1344	1/2012
Glenallan	1966		1418	8/2013
Beverly Farms	1965		1427	8/2013
Weiler Road	1953	1975	1461	8/2013
Bel Pre	1968		1476	8/2014
Candlewood	1968		1489	1/2015
Rock Creek Forest	1950	1971	1492	1/2015
Wayside	1969		1502	8/2016
Brown Station	1969		1516	8/2016
Wheaton Woods	1952	1976	1525	8/2016
Potomac	1949	1976	1550	1/2018
Luxmanor	1966		1578	1/2018
Maryvale	1969		1578	1/2018
Sandburg	1962		****	TBD
<b>Middle</b>				
Parkland	1963		<b>1409</b>	8/2007
Francis Scott Key	1967		1389	8/2009
Cabin John	1968		1422	8/2011
Herbert Hoover	1966		1427	8/2013
William H. Farquhar	1968		1434	8/2015
Tilden @ Woodward	1966		1455	8/2017
Eastern	1951	1976	1472	TBD
E. Brooke Lee	1966		1479	TBD
<b>High</b>				
Richard Montgomery	1942	1976	1287	8/2007
Walter Johnson	1956	1977	1405	8/2009
Paint Branch	1969		1425	8/2011
Gaithersburg	1951	1978	1214	8/2012
Wheaton	1954	1983	1220	8/2014
Seneca Valley	1974		1254	8/2016
Thomas S. Wootton	1970		1301	8/2018
Poolesville	1953	1978	1362	TBD
Col. Zadok Magruder	1970		1471	TBD
Damascus	1950	1978	1496	TBD

**Bold FACT scores** are from the 1992 assessment and indicate schools that are on the adopted modernization schedule.  
**Italicized Fact scores** are for the seven high schools that were assessed in 1999 that have been appended to the list of high schools in the schedule.  
**Note:** All other FACT scores are from the 1996 assessment. This listing displays those schools added to the end of the 1992 adopted list. There is some overlap in scores due to the four-year gap in dates of the assessments. Schools on the 1992 list would have been four years older and may have had lower scores. Five schools from both lists were assessed at the same time. No building of schools from the 1992 assessment in the adopted schedule is recommended. Funds were approved in FY 1999 to perform the assessments for the seven remaining high schools. No funds have been allocated to complete the assessment of the remaining 43 elementary and middle schools that were built/renovated between 1970-1983.  
**TBD** Projects that do not have planning and/or construction expenditures in the Superintendent's Recommended FY 2009-2014 CIP have completion dates to be determined (TBD). This TBD status will be revised in a future CIP.

Darrestown ES

1954

1980

Not assessed yet

TBD

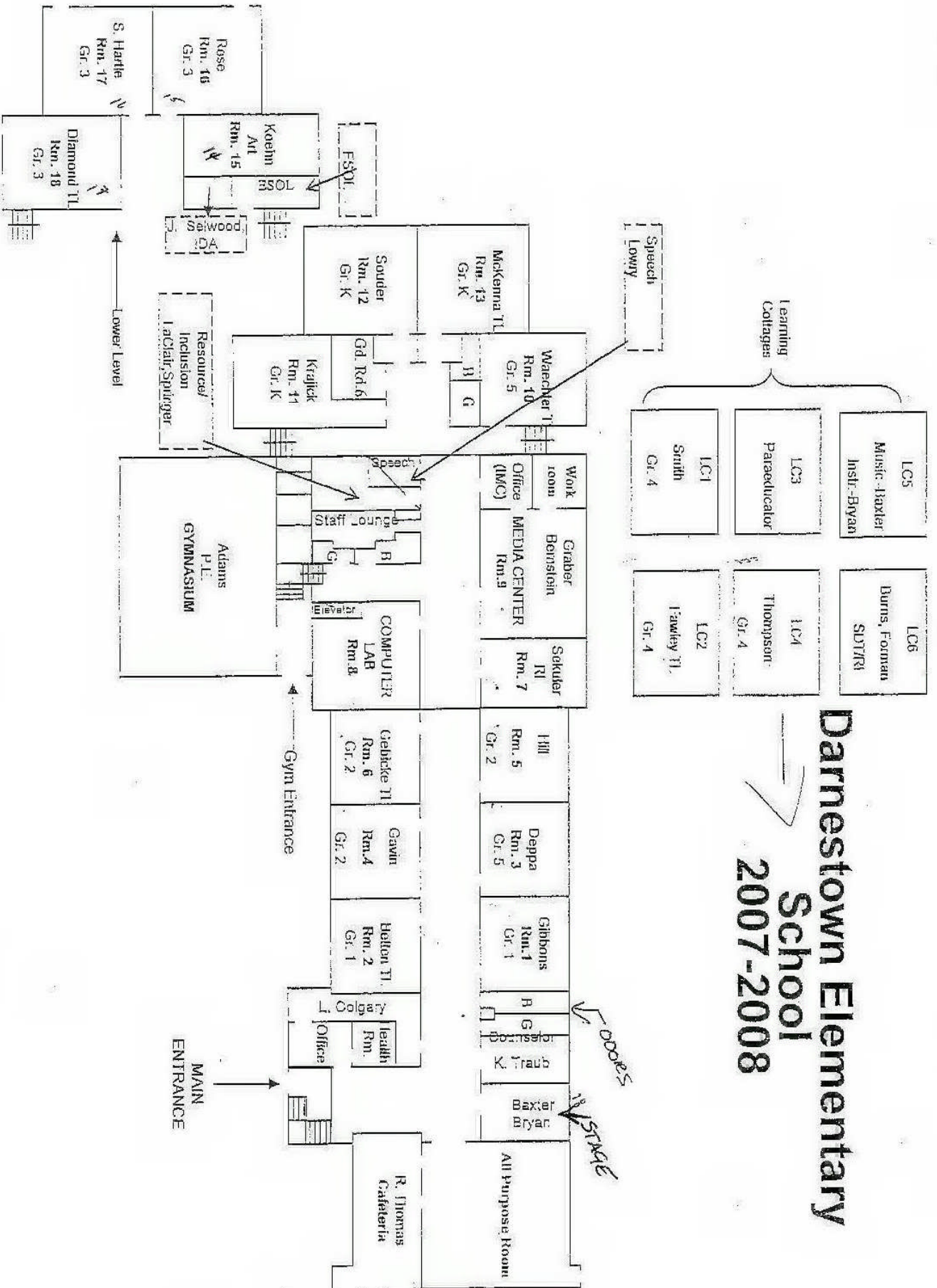

# Darnestown Elementary School

2007-2008

# BUILDING HISTORY DIAGRAM

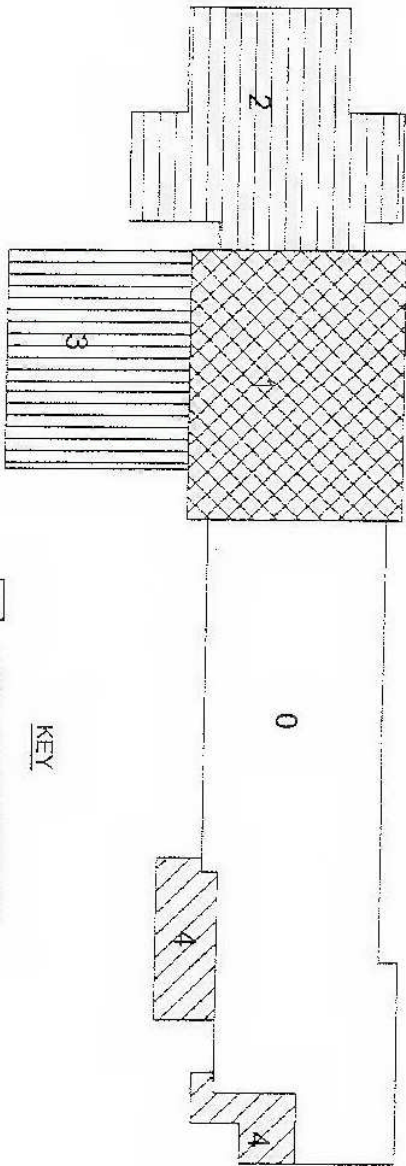

## KEY

- 0 ORIGINAL BUILDING (1974) 12,813 S.F.
- 2 ADDITION (1960) 5,210 S.F.
- 3 ADDITION (1974) 4,718 S.F.
- 4 ADDITION (1979) 2,107 S.F.

DARNESTOWN ELEMENTARY SCHOOL

SCALE: N.T.S.